



Metal Enclosure Box





Galvanized Steel Enclosure Box

CCM metal enclosure boxes are made from high-quality galvanized steel, double folded at the front and back welded to the frame, and coated both internally and externally with polyester epoxy resin grey paint RAL-7032. CCM enclosure boxes are rated IP66, providing exceptional resistance in the most extreme weather conditions and environments. Complete range of accessories included and multiple sizes available to cater to a wide variety of applications.



- IP66 protection rating
- Easy mounting with integrated wall-mount system
- Key lock for additional security with an IP rated cap that provides water resistance when mounted outdoor
- Grounding cable from door to enclosure

Accessories included:

- 4pcs M8*16 Bolt
- 4pcs M8 Washer
- 4pcs M8 Spring Washer
- 4pcs M8 Nut
- 4pcs Wall Mounting Brackets
- 1 pair of key
- Replacement key available (ENMKC.CCM)



Product Specification

Stock Code	Height (mm)	Width (mm)	Depth (mm)	Weight (kg)
ENM202015.CCM	200	200	150	2.5
ENM252015.CCM	250	200	150	3
ENM302015.CCM	300	200	150	3.5
ENM302515.CCM	300	250	150	5
ENM303020.CCM	300	300	200	5.5
ENM403020.CCM	400	300	200	7
ENM404020.CCM	400	400	200	8.5
ENM504020.CCM	500	400	200	10
ENM505025.CCM	500	500	250	13
ENM604020.CCM	600	400	200	11.5
ENM604025.CCM	600	400	250	12.5
ENM605020.CCM	600	500	200	14
ENM605025.CCM	600	500	250	15.5
ENM705025.CCM	700	500	250	17
ENM806030.CCM	800	600	300	19

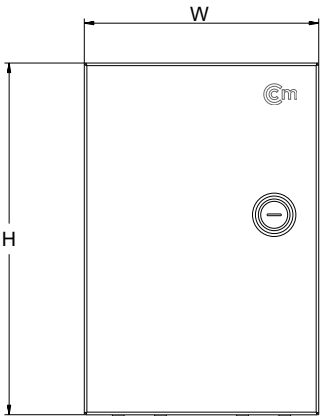

FRONT

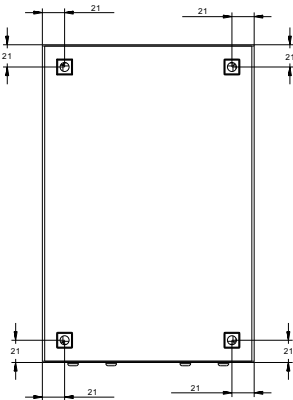

REAR

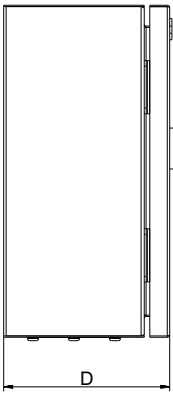

SIDE

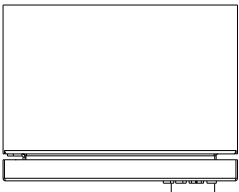

TOP

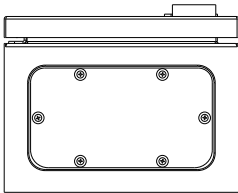

BELOW

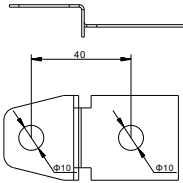

MOUNTING BRACKET





Solely Distributed by
Choo Chiang Marketing Pte Ltd
10 Woodlands Loop S(738388)
+65 63685922
www.choochiang.com
info@choochiang.com